

**Wash basin for recessing into worktop**



- Wash basin in AISI 304 stainless steel.
- Satin finish. Also available in polish finish (NOFER 13028.RB).
- For recessing into worktop.
- With overflow hole Ø 28 mm.
- Drainage valve, grating and overflow trap are optional.

**TECHNICAL DATA**

- Made of AISI 304 stainless steel.
- Dimensions: Ø int. 260 mm, Ø ext. 305 mm, 110 mm high.
- Maintenance: stainless steel needs maintenance because dust can eventually damage the chrome in AISI 304 stainless steel. We recommend monthly cleaning with our special product.

**SUGGESTED TEXT FOR PRESCRIPTION**

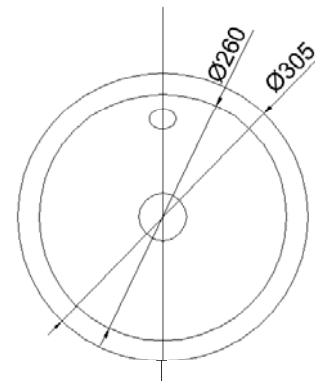
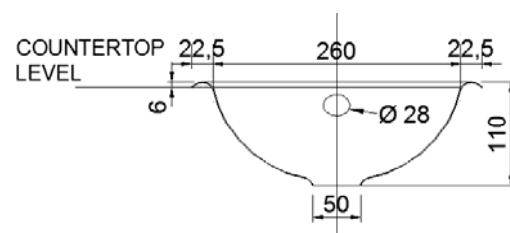
NOFER or similar wash basin, in AISI 304 stainless steel, satin finished. For recessing into worktop, with overflow hole.  
 Dimensions: Ø int. 260 mm, Ø ext. 305 mm, 110 mm high

**TECHNICAL DRAWING**

Dimensions in mm



NOFER S.L.  
 Avenida de la fama, 118  
 08940 · Cornellà de Llobregat (Barcelona)  
 Tel +34 934 742 423 · Fax +34 934 743 548  
 export@nofer.com · www.nofer.com

Related Products

